

C LEVEL HOSPITAL MAP

- STAIRWELL
- LIFT
- MALE WC
- FEMALE WC
- ACCESSIBLE WC
(RIGHT HANDED TRANSFER)
- BABY CHANGING ROOM
- BABY FEEDING ROOM
- RESTAURANT
- SECURITY
- PHARMACY
- PUBLIC PHONACASH POINT
- PUBLIC PHONE

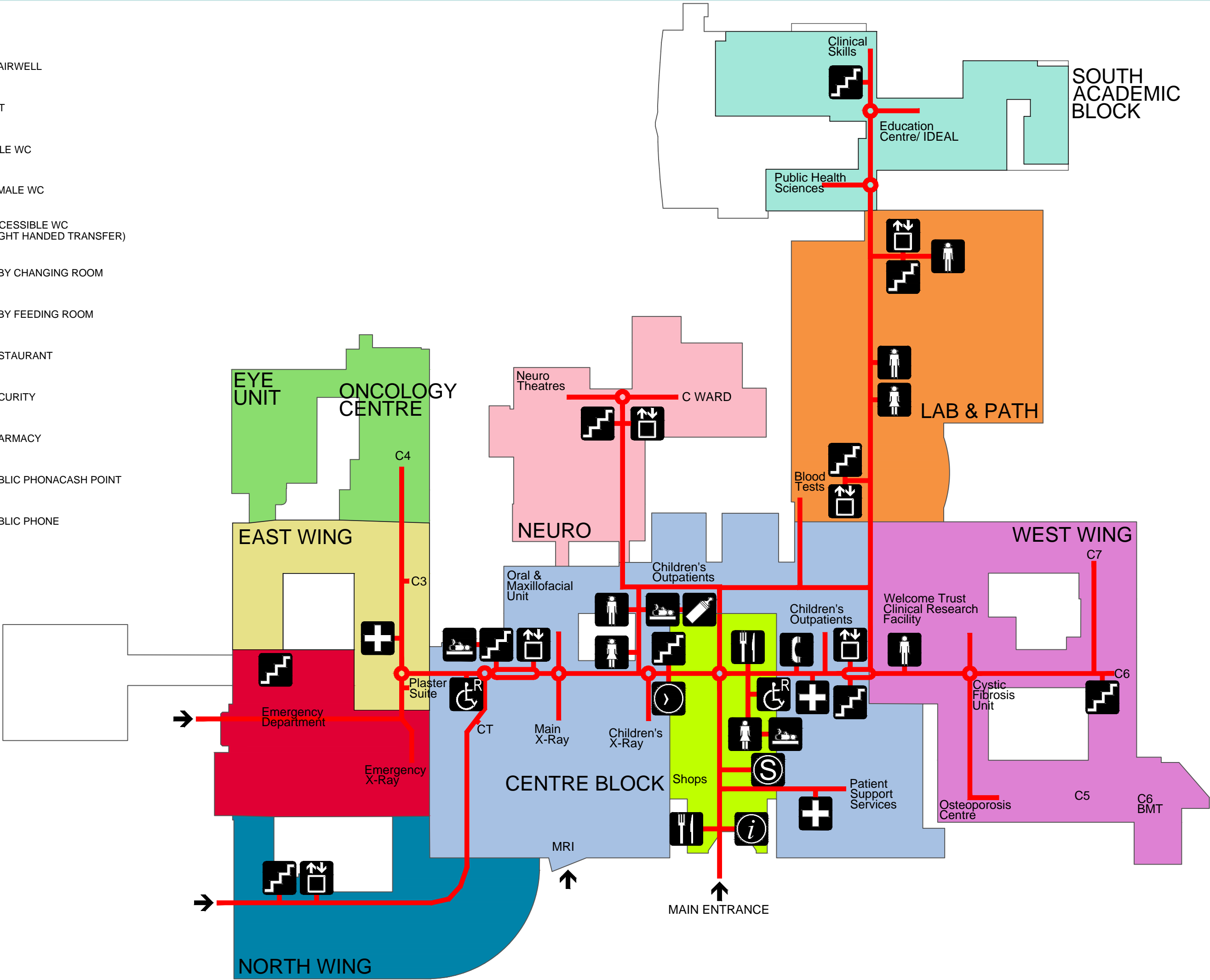

C